

T 21S, R 7E M W

A	1	2	3	4	5	6	7	8	9	10	11	12	13	14	15	16	17	18	19	20	21	22	23	24	25
B	+	+	+	+	+	+	+	+	+	+	+	+	+	+	+	+	+	+	+	+	+	+	+	+	+
C	+	6	+	+	5	+	+	+	+	4	+	+	3	+	+	+	2	+	+	+	+	1	+	+	+
D	+	+	+	+	+	+	+	+	+	+	+	+	+	+	+	+	+	+	+	+	+	+	+	+	+
E	⊗	+	+	+	+	+	+	+	+	+	+	+	+	+	+	+	+	+	+	+	+	+	+	+	+
F	+	+	+	+	+	+	+	+	+	+	+	+	+	+	+	+	+	+	+	+	+	+	+	+	+
G	+	7	+	+	8	+	+	+	+	9	+	+	10	+	+	+	11	+	+	+	+	12	+	+	+
H	+	+	+	+	+	+	+	+	+	+	+	+	+	+	+	+	+	+	+	+	+	+	+	+	+
I	⊗	+	+	+	+	+	+	+	+	+	+	+	+	+	+	+	+	+	+	+	+	+	+	+	+
K	+	+	+	+	+	+	+	+	+	+	+	+	+	+	+	+	+	+	+	+	+	+	+	+	+
L	+	18	+	+	17	+	+	+	+	16	+	+	15	+	+	+	14	+	+	+	+	13	+	+	+
M	+	+	+	+	+	+	+	+	+	+	+	+	+	+	+	+	+	+	+	+	+	+	+	+	+
N	⊗	+	+	+	+	+	+	+	+	+	+	+	+	+	+	+	+	+	+	+	+	+	+	+	+
O	+	+	+	+	+	+	+	+	+	+	+	+	+	+	+	+	+	+	+	+	+	+	+	+	+
P	+	19	+	+	20	+	+	+	+	21	+	+	22	+	+	+	23	+	+	+	+	24	+	+	+
Q	+	+	+	+	+	+	+	+	+	+	+	+	+	+	+	+	+	+	+	+	+	+	+	+	+
R	⊗	+	+	+	+	+	+	+	+	+	+	+	+	+	+	+	+	+	+	+	+	+	+	+	+
S	+	+	+	+	+	+	+	+	+	+	+	+	+	+	+	+	+	+	+	+	+	+	+	+	+
T	+	30	+	+	29	+	+	+	+	28	+	+	27	+	+	+	26	+	+	+	+	25	+	+	+
U	+	+	+	+	+	+	+	+	+	+	+	+	+	+	+	+	+	+	+	+	+	+	+	+	+
V	+	+	+	+	+	+	+	+	+	+	+	+	+	+	+	+	+	+	+	+	+	+	+	+	+
W	+	+	+	+	+	+	+	+	+	+	+	+	+	+	+	+	+	+	+	+	+	+	+	+	+
X	⊗	+	31	+	+	32	+	+	+	33	+	+	34	+	+	+	35	+	+	+	+	36	+	+	+
Y	⊗	+	+	+	+	+	+	+	+	+	+	+	+	+	+	+	+	+	+	+	+	+	+	+	+

LEGEND

⊙ = Corner having information on form 7100-52 in this file.

Legend Confirms to Reporting form 11/3/79

FILING INSTRUCTION

File 7100-52 card record by letter and number coordinates behind the file guide for the township in which it falls.

File the 7100-52 card record by letter and then by number i.e., all A cards first, then B cards etc.

The first card behind the file guide (if data have been obtained and recorded) will be card A-1 for N.W. Township Corner, then card A-2 for 1/16 corner then card A-3 for 1/4 corner etc.

Index File No. 0155 CORNER RECORD (SEARCH) Contract or Survey No. E-01
 (Ref. FSM 7151.4)
 T 21 S. R. 7 E. R.D. BEND County DESCHUTES STD Cor. of 16
 Merid. Willamette N.F. Deschutes State Oregon Section 16

CORNER DIAGRAM per legend

DESCRIBE CORNER MONUMENT FOUND 127

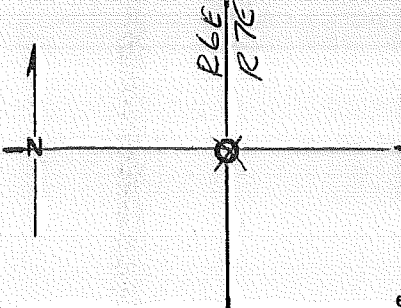

DESCRIBE BEARING TREES OR OTHER OFFICIAL ACCESSORIES FOUND 2

4 BTs

PHOTO IDENTIFICATION DATA

Photo No. _____
 Filed At. _____
 Object Ident. _____
 Ident. By _____
Signature

DESCRIBE CORNER LOCATION RELATIVE TO NEAR-BY FEATURES, ALSO HOW TO REACH CORNER 3

CORNER LEGEND:

- FS or Unverified
- Contr. Other
- ◇ Searched For/Not Found
- ⊗ ⊗ Evidence Found/Accept.
- ◆ Permanent Mon. Set/Fd.

Searched By: _____ Title _____ Division _____ Headquarters _____ Date ca 1968 5

CORNER RECORD (PERPETUATION)

MONUMENT. DESCRIBE NEW MONUMENT SET, OR WORK DONE TO PRESERVE EXISTING MONUMENT

MONUMENT STAMPED

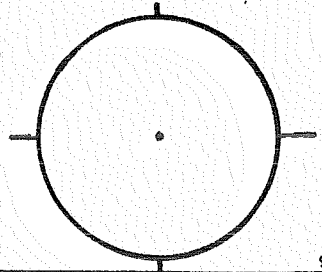

ACCESSORIES DESCRIBE NEW BT'S WITNESS OBJECTS ETC. ESTABLISHED, OR WORK DONE TO PRESERVE EXISTING EVIDENCE

Work Done By _____ Title _____ Date _____ State Registration No. _____
or Agency _____

Flat or Certified Cor. Record Prepared? Yes No Filed At _____ Co. Surveyor's Office Date _____

History of Surveys, G.L.O., etc. _____

Index File No T. S., R. E., W.M. Contract or Surv. No Cor.

Index File No. 0159 CORNER RECORD (SEARCH) Contract or Survey No. J-01
(Ref. FSM 7151.4)

T 21 S. R. 7 E. R.D. BEND County DESCHUTES STD Cor. of
 Merid. Willamette N.F. Deschutes State Oregon Section 12/7
 13/18

CORNER DIAGRAM per legend

DESCRIBE CORNER MONUMENT FOUND

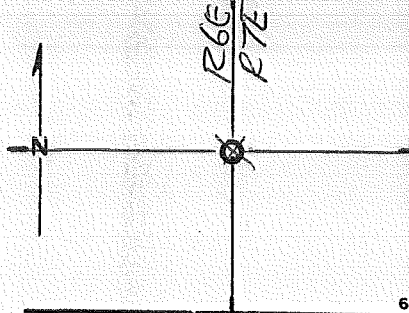

DESCRIBE BEARING TREES OR OTHER OFFICIAL ACCESSORIES FOUND

4 BT's

PHOTO IDENTIFICATION DATA

Photo No. _____

Filed At. _____

Object Ident. _____

Ident. By _____

DESCRIBE CORNER LOCATION RELATIVE TO NEAR-BY FEATURES, ALSO HOW TO REACH CORNER

Signature _____

CORNER LEGEND:

- FS or Unverified
- Contr. Other
- ◇ Searched For/Not Found
- ⊗ ⊗ Evidence Found/Accept.
- ◆ Permanent Mon. Set/Fd.

Searched By: _____ Title _____ Division _____ Headquarters _____ Date ca 1968

CORNER RECORD (PERPETUATION)

MONUMENT. DESCRIBE NEW MONUMENT SET, OR WORK DONE TO PRESERVE EXISTING MONUMENT

MONUMENT STAMPED

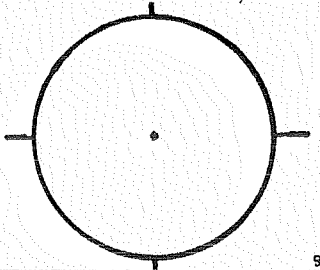

ACCESSORIES. DESCRIBE NEW BT'S WITNESS OBJECTS ETC. ESTABLISHED, OR WORK DONE TO PRESERVE EXISTING EVIDENCE

Work Done By _____ Title _____ Date _____ State Registration No. or Agency _____
Certified Cor. Record Prepared? Yes No Filed At _____ Co. Surveyor's Office Date _____

History of Surveys, G.L.O., etc.

Index File No. T. S., R. E., W.M. Contract or Surv. No. Cor.

Index
 File No. 0163 CORNER RECORD (SEARCH) Contract or Survey No. N-01
 (Ref. FSM 7151.4)
 T 21 S. R. 7 E. R.D. BEND County DESCHUTES STD Cor. of 13/18
 Merid. Willamette N.F. Deschutes State Oregon Section 24/19

CORNER DIAGRAM, per legend

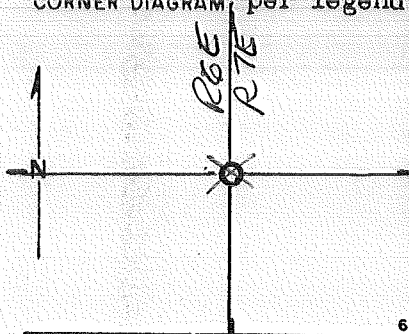

DESCRIBE CORNER MONUMENT FOUND

DESCRIBE BEARING TREES OR OTHER OFFICIAL ACCESSORIES FOUND

4 BT'S

PHOTO IDENTIFICATION DATA

Photo No. _____
 Filed At. _____
 Object Ident. _____
 Ident. By _____
 Signature _____

DESCRIBE CORNER LOCATION RELATIVE TO NEAR-BY FEATURES, ALSO HOW TO REACH CORNER

CORNER LEGEND:
 FS or Contr. Unverified Other
 ○ ◊ Searched For/Not Found
 ⊗ ⊗ Evidence Found/Accept.
 ● ◆ Permanent Mon. Set/Pd.

Searched By: _____ Title _____ Division _____ Headquarters _____ Date ca 1968

CORNER RECORD (PERPETUATION)

MONUMENT: DESCRIBE NEW MONUMENT SET, OR WORK DONE TO PRESERVE EXISTING MONUMENT

MONUMENT STAMPED

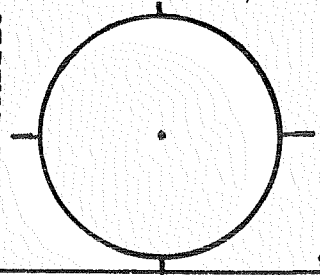

9

ACCESSORIES: DESCRIBE NEW BT'S WITNESS OBJECTS ETC. ESTABLISHED, OR WORK DONE TO PRESERVE EXISTING EVIDENCE

10

Work Done By _____ Title _____ Date _____ State Registration No. or Agency _____

Plat or Certified Cor. Record Prepared? Yes No Filed At _____ Co., Surveyor's Office Date _____

11

History of Surveys, G.L.O., etc. _____

12

Index File No T. S., R. E., W.M. Contract or Surv. No Cor. 13

LAND CORNER RECORD

N-25 5680-2

(Rectangular)

1. T. 21S R. 7E No. 1324 Cor. SEC Mer. WN State Oregon N.F. Deschutes Dist. Bnd

2. Corner Status N-25

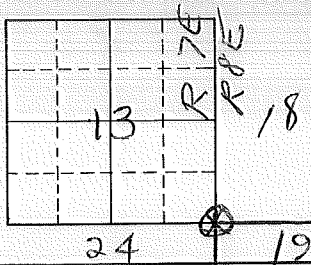

3. Original Description _____ Vol. _____ Page _____ Where Recorded _____

4. Description of Corners:

5. Investigation Notes:

Two Bearing Trees Found:
Species: Jackpine
Diameter: 14" 9" (NE & SE)

7. Photo Identification

Photo No. _____
Ident. By: _____

8. Plane Coordinate Position Data

State _____ Zone _____
X _____
Y _____
Estab. By _____
Field Book No. _____
Where Filed _____

9. Evaluation

Authentic _____
Needs Verif. _____ Monument _____
Re-estab. _____ Survey _____
Land Status _____

6. Signed _____ Title _____ Date _____

PERPETUATION RECORD

10. Monument :

11. Accessories

Field Book _____ Page _____

12. Set By _____ Title _____

13. Recorded By _____ Volume _____ Page _____

License _____ Agency _____ Date _____

(Agency) _____
(Date) _____ (City) _____ (County) _____ (State) _____

14. Remarks:

Index File No. 0167 CORNER RECORD (SEARCH) Contract or Survey No. R-01
 (Ref. FSM 7151.4) T 21 S. R. 7 E. R.D. BOND County DESCHUTES STD C.C. of 24/19
 Merid. Willamette N.F. Deschutes State Oregon Section 24/19

CORNER DIAGRAM per legend

DESCRIBE CORNER MONUMENT FOUND 25/30

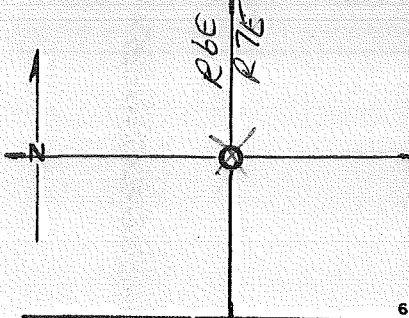

DESCRIBE BEARING TREES OR OTHER OFFICIAL ACCESSORIES FOUND 2

4 BTs

PHOTO IDENTIFICATION DATA

Photo No. _____

Filed At. _____

Object Ident. _____

Ident. By _____

DESCRIBE CORNER LOCATION RELATIVE TO NEAR-BY FEATURES, ALSO HOW TO REACH CORNER 3

CORNER LEGEND:

- FS or Unverified
- Contr. Other
- ◇ Searched For/Not Found
- ⊗ ⊗ Evidence Found/Accept.
- ◆ Permanent Mon. Set/Fd.

Searched By: _____ Title _____ Division _____ Headquarters _____ Date ca 1968

CORNER RECORD (PERPETUATION)

MONUMENT STAMPED

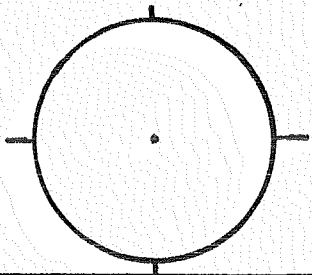

MONUMENT: DESCRIBE NEW MONUMENT SET, OR WORK DONE TO PRESERVE EXISTING MONUMENT

ACCESSORIES: DESCRIBE NEW BT'S WITNESS OBJECTS ETC. ESTABLISHED, OR WORK DONE TO PRESERVE EXISTING EVIDENCE

Work Done By _____ Title _____ Date _____ State Registration No. or Agency _____
Certified For Record Prepared? Yes No Filed At _____ Co. Surveyor's Office Date _____

History of Surveys, G.L.O., etc.

Index File No. T. S., R. E., W.M. Contract or Surv. No. Cor.

LAND CORNER RECORD

R-25 5680-2

(Rectangular)

1. 215 R 742 No. R-25 Cor. Sec. Merlon State Oregon N.F. Deschutes Dist. Bend

2. Corner Status

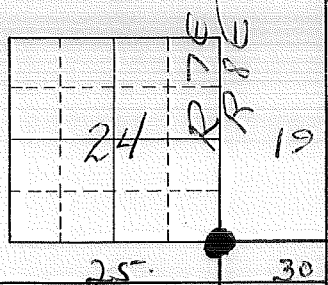

3. Original Description _____ Vol. _____ Page _____ Where Recorded _____

4. Description of Corners:
 Condition - Post on ground.
SEE: R-01 T215 R8E

5. Investigation Notes:
One Bearing Tree Found BC
Species: J.P.
Diameter: 20"
Tree is down.

7. Photo Identification

Photo No. _____
 Ident. By: _____

8. Plane Coordinate Position Data

State _____ Zone _____
 X _____
 Y _____
 Estab. By _____
 Field Book No. _____
 Where Filed _____

9. Evaluation

Authentic _____
 Needs Verif. _____ Monument _____
 Re-estab. _____ Survey _____
 Land Status _____

6. Signed C. Cox Title _____ Date 6-16-61

PERPETUATION RECORD

10. Monument :

11. Accessories

Field Book _____ Page _____

12. Set By _____ Title _____
License _____ Agency _____ Date _____

13. Recorded By _____ (Agency) _____ Volume _____ Page _____
(Date) (City) (County) (State)

14. Remarks:

Index

File No. T-25

T 213 R. 7E

Merid. Will

CORNER RECORD (SEARCH)

(Ref. FSM 7151.4)

R.D. 2 County DES

N.F. DES State OR

Tract or Survey No. _____

Cor. No. T-25

E/A Coy. Sec. 25
W/A Coy. Sec.

CORNER DIAGRAM

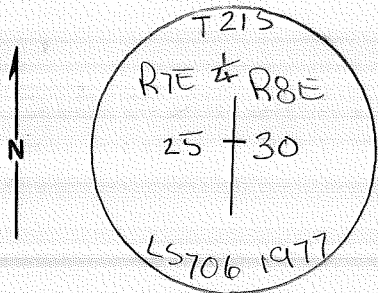

DESCRIBE CORNER MONUMENT FOUND

SEE: T-01
T 215 R 8E

DESCRIBE BEARING TREES OR OTHER OFFICIAL ACCESSORIES FOUND

For Trees and B.T.s see Oman's Card

PHOTO IDENTIFICATION DATA

Photo No. _____

Filed At. _____

Object Ident. _____

Ident. By _____

Signature

PLANE COORDINATE POSITION DATA

State _____ Zone _____

X _____

Y _____

Estab. By _____

Agency

Signature

Title

Division

Headquarters

Date

7100-52 (3-68)

CORNER RECORD (PERPETUATION)

MONUMENT: DESCRIBE NEW MONUMENT SET, OR WORK DONE TO PRESERVE EXISTING MONUMENT

Pipe Cap

9

ACCESSORIES : DESCRIBE NEW BT'S WITNESS OBJECTS ETC. ESTABLISHED, OR WORK DONE TO PRESERVE EXISTING EVIDENCE

10

Work Done By B. Rogers Title Cad. Surveyor Date 10/77 State Registration No. LS 706
or Agency

Certified Cor. Record Prepared? Yes No Filed At: _____ Date _____

11

REMARKS

For Ties and B.T.s see Oman's Card

12

Index File No. T-25 T.

R.

M.

Tract or Surv. No.

Cor. T-25¹³

D-7100-52 d (10/78)
USDA-FOREST SERVICE

Index
File No. _____
CORNER RECORD (SEARCH) (Ref. FSM 7151.4) Tract or Survey No. _____ Cor. No. V-25
T 21 S. R. 7 E. R.D. BEND County DESCHUTES Sec. Cor.
Merid. WILLAMETTE N.F. DESCHUTES State OREGON

BE: V-1

T 21 S R 8 E

BE Set

LAND CORNER RECORD

X-01 5680-2

1. T 21S, R 7E, No. X-1 Cor. 1/4 Mer. Will State OREGON (Rectangular) N. F. DESCHUTES Dist. BEND

2. Corner Status

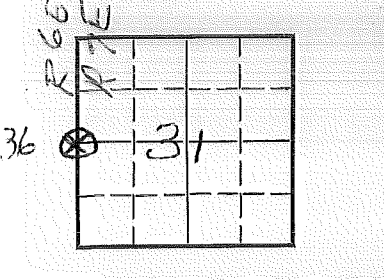

3. Original Description _____ Vol. _____ Page _____ Where Recorded _____

4. Description of Corners:

5. Investigation Notes:

SEE: X-25, T21S, R6E, WM

1 BT snag 1965

7. Photo Identification

Photo No. _____
Ident. By: _____

9. Plane Coordinate Position Data

State _____ Zone _____

X _____

Y _____

Estab. By _____

Field Book No. _____

Where Filed _____

9. Evaluation

Authentic _____

Needs Verif. _____ Monument _____

Re-estab. _____ Survey _____

Land Status _____

6. Signed _____ Title _____ Date _____

Index
File No.

T 21 S. R. 7 E.

Merid. WILLAMETTE

CORNER RECORD (SEARCH)

(Ref. FSM 7151.4)

R.D. BEND County

N.F. DESCHUTES State

Tract or
Survey No.

DESCHUTES

OREGON

Cor.
No.

X-25

E/4 Coy. SEC. 36

W/4 Coy. SEC. 31

SEE: X-01

T21S R8E

ACK

Index File No. _____

CORNER RECORD (SEARCH)

Tract or Survey No. _____

Cor. No. Z-01
~~A-25~~

T 21S., R. 7E

R.D. Crescent County Deschutes

Sec Cor

Merid. Will

N.F. Deschutes State Oregon

CORNER DIAGRAM

DESCRIBE CORNER MONUMENT FOUND

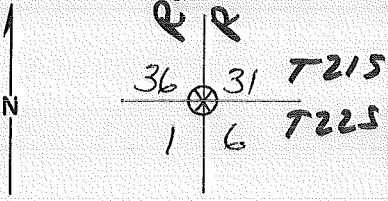

SEE: A-25, T21S, R6E, WM

DESCRIBE BEARING TREES OR OTHER OFFICIAL ACCESSORIES FOUND

PHOTO IDENTIFICATION DATA

Photo No. _____
Filed At. _____
Object Ident. _____
Ident. By _____
Signature

BT'S PD

DESCRIBE CORNER LOCATION RELATIVE TO NEAR-BY FEATURES, ALSO HOW TO REACH CORNER

PLANE COORDINATE POSITION DATA

State _____ Zone _____
X _____
Y _____
Estab. By _____
Agency

Signature

Title

Division

Headquarters

Date

7100-52

REV. 65 5

LAND CORNER RECORD

2-05 5680-2

1. T. 21S R. 7E No. ~~Z-77~~⁵ Cor. Sec Mer. WILL State ^(Rectangular) OREGON N. F. DESCHUTES Dist. CRESCENT

2. Corner Status

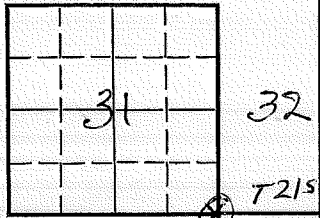

3. Original Description _____ Vol. _____ Page _____ Where Recorded _____

4. Description of Corners: Sec corner common to Secs. 32, 31, 61 and 5. Corner consists of a stake in place - condition poor - newstake support. Dimensions above ground 2'.

5. Investigation Notes:

Bearing Trees:

- Hem. - dia. 14", bears 32°, dist. 16'
- Hem. - dia. 10", bears 70°, dist. 23'
- Hem. - dia. 14", bears 126°, dist. 9'
- Hem. - dia. 15", bears 210°, dist. 23'

Meal Location Poster is on a hemlock tree 14" dia., on the NW side of bearing tree from which this corner bears 32°, 16'. Bearing tree in section 32 is dead and down. Top lying across corner stake.

7. Photo Identification

Photo No. _____
Ident. By: _____

8. Plane Coordinate Position Data

State _____ Zone _____
X _____
Y _____
Etab. By _____
Field Book No. _____
Where Filed _____

9. Evaluation

Authentic _____
Needs Verif. _____ Monument _____
Re-estab. _____ Survey _____
Land Status _____

6. Signed L. ANDERSON Title _____ Date 8-19-60

LAND CORNER RECORD

2-13 5680-2

1. T 21S, R 7E, No. 2-13 Cor. Sec Mer Will State OREGON (Rectangular) N. F. DESCHUTES Dist. CRESCENT

2. Corner Status

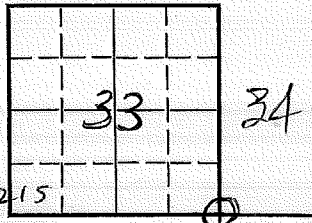

7. Photo Identification

Photo No. _____
Ident. By: _____

8. Plane Coordinate Position Data

State _____ Zone _____
X _____
Y _____
Estab. By _____
Field Book No. _____
Where Filed _____

9. Evaluation

Authentic _____
Needs Verif. _____ Monument _____
Re-estab. _____ Survey _____
Land Status _____

3. Original Description _____ Vol. _____ Page _____ Where Recorded _____

4. Description of Corners: Set corners common to sections 33, 34, 4 and 3. Corner consists of a stake in place of which the condition is good. Dimensions above ground 2'6".

5. Investigation Notes:
No Bearing trees.
Believed notto be a genuine land office corner because stake is on approx. line and placed ther 8-27-58 by R.S. Metal location poster is on a ponderosa pine tree 46" diam. on the south side of tree, from which this corner bears 238°, 34'.

6. Signed L. Anderson Title _____ Date 9-9-60

LAND CORNER RECORD

2-15 5680-2

1. T. 21S R. 7E No. 2-15 Cor. 1/4 Mer. WILL State ^(Rectangular) OREGON N. F. DESCHUTES Dist. CRESCENT

2. Corner Status

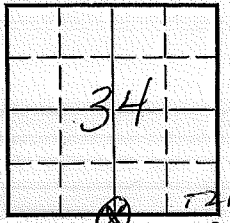

7. Photo Identification

Photo No. _____
Ident. By: _____

8. Plane Coordinate Position Data

State _____ Zone _____
X _____
Y _____
Estab. By _____
Field Book No. _____
Where Filed _____

9. Evaluation

Authentic _____
Needs Verif. _____ Monument _____
Re-estab. _____ Survey _____
Land Status _____

3. Original Description _____ Vol. _____ Page _____ Where Recorded _____

4. Description of Corners:

5. Investigation Notes: Approx 1/4 corner common to Sections 3 and 34. Corner consists of a live tree in place that is in a living condition. Dimensions above ground 4'.
Bearing Trees:
PP - dia. 33", bearing 18°, distance 40 1/2'.
PP - dia. 42", bearing 144°, distance 48'.
Believed to be a genuine Land Office corner.
Metal Location Poster is on a PP (live) tree 33" dia., on the NE side of bearing tree from which this corner bears 18°.

6. Signed L-ANDERSON? Title _____ Date 9-9-60

LAND CORNER RECORD

2-17 5680-2

1. T. 21S R. 7E No. 2-17 Cor. Sec. Mer. WILL State ^(Rectangular) OREGON N. F. DESCHUTES Dist. CRESCENT

2. Corner Status

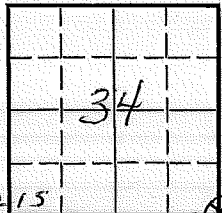

72 15
72 25



7. Photo Identification

Photo No. _____
Ident. By: _____

8. Plane Coordinate Position Data

State _____ Zone _____
X _____
Y _____
Estab. By _____
Field Book No. _____
Where Filed _____

9. Evaluation

Authentic _____
Needs Verif. _____ Monument _____
Re-estab. _____ Survey _____
Land Status _____

3. Original Description _____ Vol. _____ Page _____ Where Recorded _____

4. Description of Corners:

5. Investigation Notes: Sec Cor common to Secs. 34, 35, 2 and 3. Corner consists of a stake in place of which the condition is poor - reinforced with new. Dimensions above ground 30'. Bearing tree LP - dia. 14", bearing 130°, distance 14'. Believed to be a genuine Land Office corner.

6. Signed C. Anderson Title _____ Date 9-8-60

LAND CORNER RECORD

Z-19 5680-2

1. T. 21 S. R. 7E No. Z-19 Cor. 1/4 Mer. WILL State ^(Rectangular) OREGON N. F. DESCHUTES Dist. CRESCENT

2. Corner Status

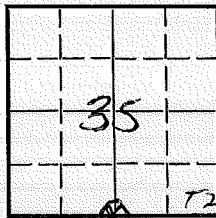

7. Photo Identification

Photo No. _____

Ident. By: _____

8. Plane Coordinate Position Data

State _____ Zone _____

X _____

Y _____

Estab. By _____

Field Book No. _____

Where Filed _____

9. Evaluation

Authentic _____

Needs Verif. _____ Monument _____

Re-estab. _____ Survey _____

Land Status _____

3. Original Description _____ Vol. _____ Page _____ Where Recorded _____

4. Description of Corners:

5. Investigation Notes: 1/4 Cor common to Secs. 2 and 35. Corner consists of a stake not in place. The condition of the stake is poor and it is supported by rocks

Bearing Tree - LP - dia. 15", bearing 234°, distance 22 1/2'.

Believed to be a genuine Land Office Corner.

6. Signed L. Anderson Title _____Date 9-9-60

LAND CORNER RECORD

2-21 5680-2

1. T. 21S R. 7E No. 2-21 Cor. SEC Mer. WILL State ^(Rectangular) OREGON N. F. DESCHUTES Dist. CRESCENT

2. Corner Status

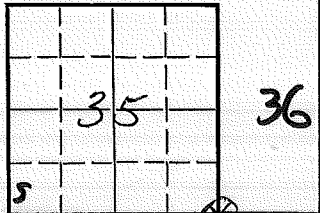

T 21 S

R 22 E

2

1

7. Photo Identification

Photo No. _____

Ident. By: _____

8. Plane Coordinate Position Data

State _____ Zone _____

X _____

Y _____

Estab. By _____

Field Book No. _____

Where Filed _____

9. Evaluation

Authentic _____

Needs Verif. _____ Monument _____

Re-estab. _____ Survey _____

Land Status _____

3. Original Description _____ Vol. _____ Page _____ Where Recorded _____

4. Description of Corners:

5. Investigation Notes: Sec. Cor. common to Secs. 35, 36, 1 and 2. Corner consists of a live tree in place of which the condition is good. Dimension above ground 3' 6".

Bearing Trees:

LP - dia. 6", bears 230°, dist. 8'

Lp - dia. 12", bears 358°, dist. 18'

LP - dia., 12", bears 160°, dist. 28'

Belived to be a genuine Land Offive Crnr.

6. Signed L. Anderson Title _____ Date 9-9-60

LAND CORNER RECORD

2-23 5680-2

1. T 21S R 7E No. 2-23 Cor. 1/4 Mer. WILL State OREGON N. F. DESCHUTES Dist. CRESCENT

2. Corner Status

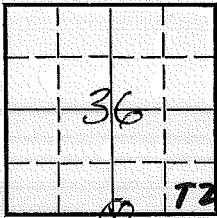

T21S
T22S

7. Photo Identification

Photo No. _____
Ident. By: _____

8. Plane Coordinate Position Data

State _____ Zone _____
X _____
Y _____
Estab. By _____
Field Book No. _____
Where Filed _____

9. Evaluation

Authentic _____
Needs Verif. _____ Monument _____
Re-estab. _____ Survey _____
Land Status _____

3. Original Description _____ Vol. _____ Page _____ Where Recorded _____

4. Description of Corners:

5. Investigation Notes: 1/4 Cor. common to Secs. 36 and 1. Corner consists of a LP tree 4" dia. in place of which the condition is liv and visible. Dimension above ground 3'.

Bearing Trees:

LP - dia. 1 1/4", bears 42°, dist. 18'
LP - (down) dia. 1 1/2", bears 188°, dist. 41'
Belived to be a genuine Land Office Corner.

6. Signed L. ANDERSON Title _____ Date 9-8-60

Index

File No. _____

CORNER RECORD (SEARCH)

(Ref. FSM 7151.4)

Tract or

Survey No. _____

Cor.

No. 2-25

T 21 S. R. 7 E.

R.D. BEND

County DESCHUTES

SEC. COR.

Merid. WILLAMETTE

N.F. DESCHUTES

State OREGON

~~SEE 2-1 T21S R2E~~

SEE A-01 22/8

BCSP

BC Set